

Installation Instruction 21

How To Install The T.P.E. CC1225 Brother TN3170/TN580/TN3185 Reset Lever & Spring

**CC1225 BROTHER TN3170/TN580/TN3185
RESET LEVER & SPRING**

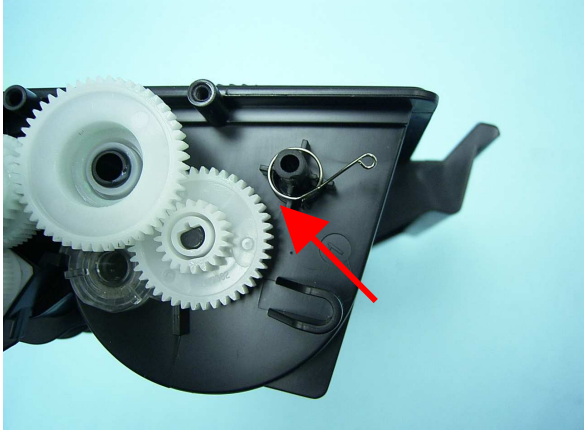
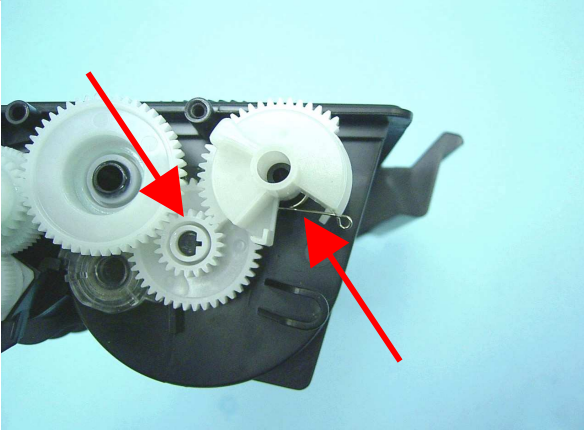

Procedures

	<p style="text-align: center;"><u>Step 1</u></p> <p>Installing the Reset Lever and Spring. The straight tail of the Spring fits into a notch at the base of the gear shaft.</p>
	<p style="text-align: center;"><u>Step 2</u></p> <p>The Reset Lever must be positioned against the stop on the right side of the hopper and the teeth of the Reset Lever should start to mesh with the other gear as shown. The Spring tail should be hooked on to the tab of the Reset Lever.</p>

Installation Instruction 21

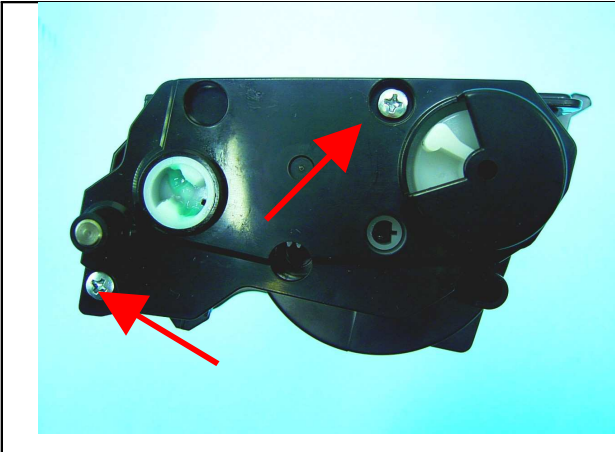

Step3

Install the gear cover plate and two screws but make sure the position of the Reset Lever is not moved. After assembly, position of the rib on the Reset Lever must be as shown.

If it has moved repeat steps 1, 2 and 3.